

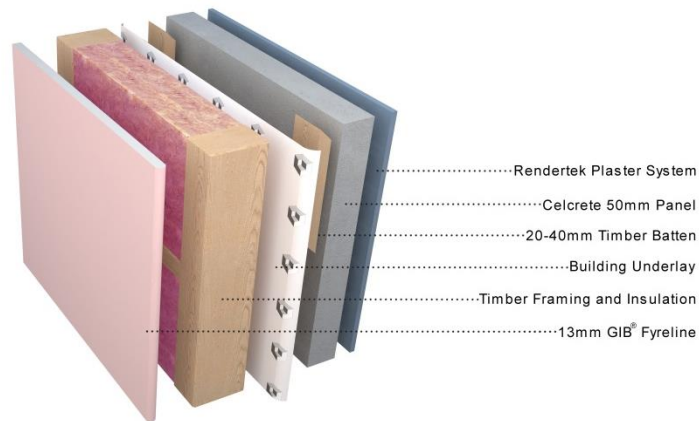

# CELCRETE

Cladding Systems NZ Ltd

Two Way FRR – Timber Frame – 60/60/60  
50mm Celcrete Panel System with 1 layer of 13mm GIB Fyreline



## FRAMING TO COMPLY WITH

- NZBC B1 – Structure:AS1 Clause3 – Timber (NZS 3604) or VM1 Clause 6 – Timber (NZS 3603)
- NZBC B2 – Durability:AS1 Clause 3.2 – Timber (NZS 3602)
- Studs at 600mm centres maximum
- Nogs at 1200mm centres for horizontal fixing

## CLADDING TO COMPLY WITH

- NZBC Clause B1 Structure
- NZBC Clause B2 Durability
- NZBC Clause E2 External Moisture
- NZBC Clause F2 Hazardous Building Materials

## WALL HEIGHTS

- Loadbearing – Framing dimensions and height as determined by NZS 3604 stud and top plate tables for load bearing walls.

## LININGS

- 1 layer of 13mm GIB Fyreline Plasterboard on the inside of the frame
- Vertical or horizontal fixing permitted.. Sheets shall be touch fitted.
- When fixing vertically, full height sheets shall be used where possible.
- All sheet joints must be formed over solid timber framing

## LINING FASTENERS

- 41mm x 6g GIB Grabber High Thread Drywall Screws or
- 40mm x 2.8mm GIB Nails

## LINING FASTENER CENTRES

- 300mm centres on the sheet perimeter.
- Place fasteners 12mm from bound sheet edges and 18mm from sheet ends.

- Single screws or nails at 300mm centres to intermediate studs

## LININGS JOINTING

- All fastener heads stopped and all sheet joints tape reinforced and stopped in accordance with the publication entitled ‘GIB Site Guide’

## CLADDING

- 1 layer of 50mm Celcrete panel installed over a timber batten

## CLADDING FASTENER CENTRES

- No closer that 50mm from the perimeter of the panel
- 2 screws per panel per stud
- Screws to be just below the surface of the panel

## CLADDING MORTAR JOINS

- Where panels join another panel or joints must use Rendertek Panel Adhesive to mortar the panels together

## BATTENS

- 20mm minimum thickness – to give 20mm minimum width cavity
- 40mm minimum width
- H3.2 treated
- SG6 grade radiate pine timber
- 75mm x 3.15mm hot dip galvanised
- Fasteners at 300mm centres

Celcrete Cladding Systems NZ Ltd. 81 Maleme Street, Tauranga, New Zealand.

Ph: 07 579 5277 Email: [celcrete@xtra.co.nz](mailto:celcrete@xtra.co.nz) [www.celcrete.co.nz](http://www.celcrete.co.nz)